

© this drawing and the building works depicted are the copyright of idp and may not be reproduced or amended except by written permission. no liability will be accepted for amendments made by other persons.

all dimensions to be checked on site and architect notified of any discrepancies prior to commencement. do not scale.

notes:

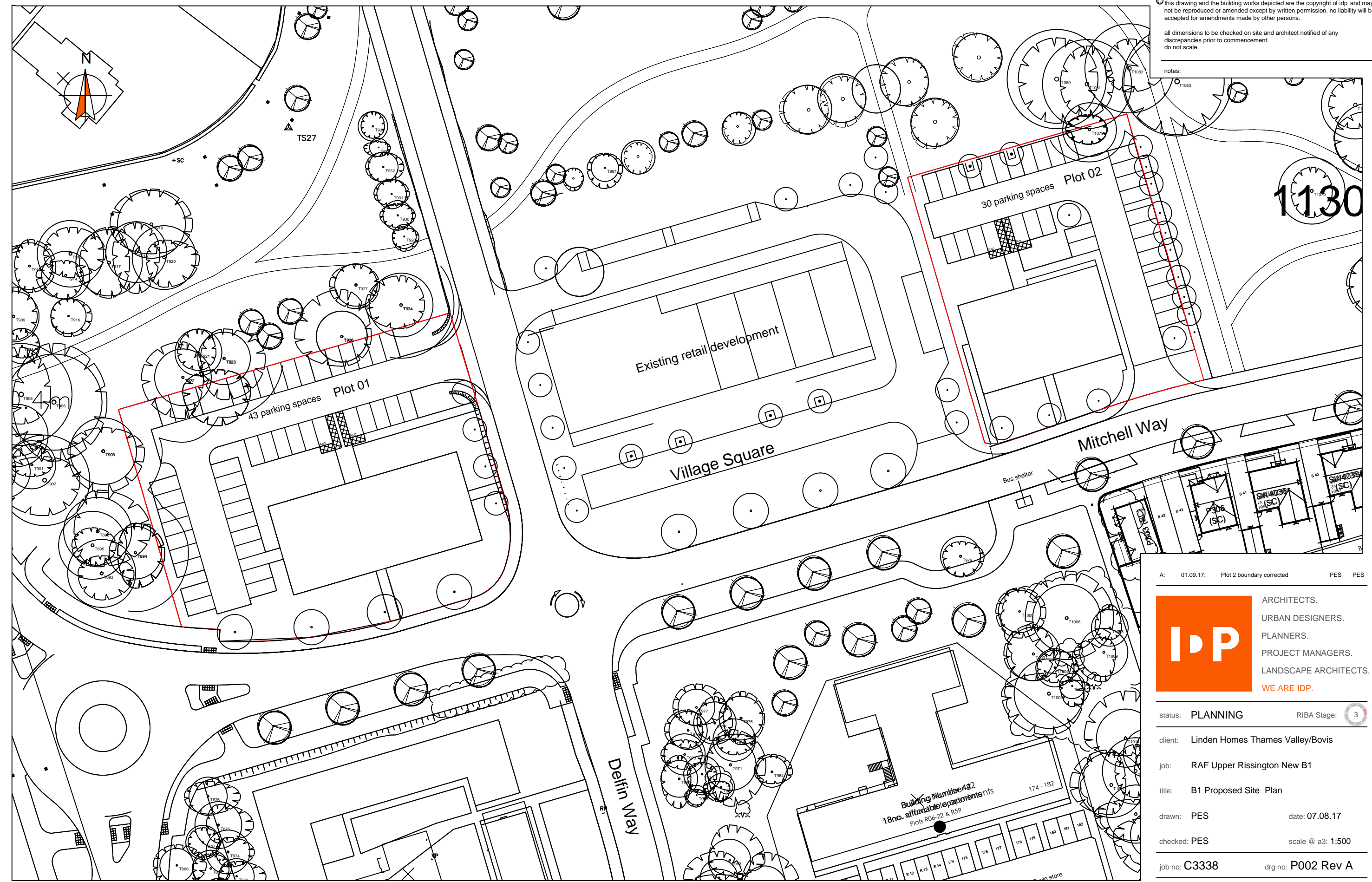

A: 01.09.17: Plot 2 boundary corrected PES PES

IDP ARCHITECTS.
 URBAN DESIGNERS.
 PLANNERS.
 PROJECT MANAGERS.
 LANDSCAPE ARCHITECTS.
 WE ARE IDP.

status: **PLANNING** RIBA Stage: **3**

client: Linden Homes Thames Valley/Bovis

job: RAF Upper Rissington New B1

title: B1 Proposed Site Plan

drawn: PES date: 07.08.17

checked: PES scale @ a3: 1:500

job no: **C3338** drg no: **P002 Rev A**

IDP GROUP 27 SPON STREET COVENTRY CV1 3BA
 T: +44 (0)24 7652 7600 E: info@idpgroup.com
www.weareidp.com