

0m 5m 10m
Scale 1 : 100

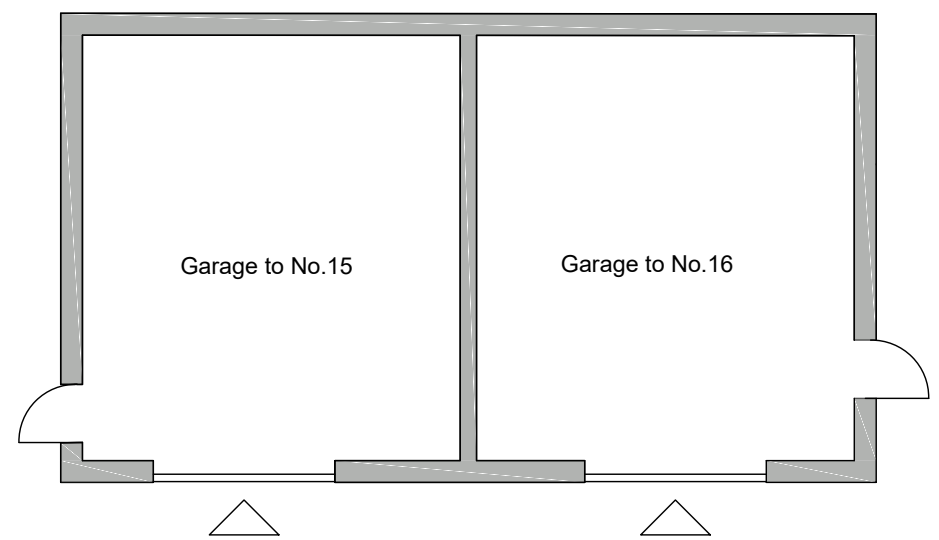

Plan
Garages to Nos. 15, 16

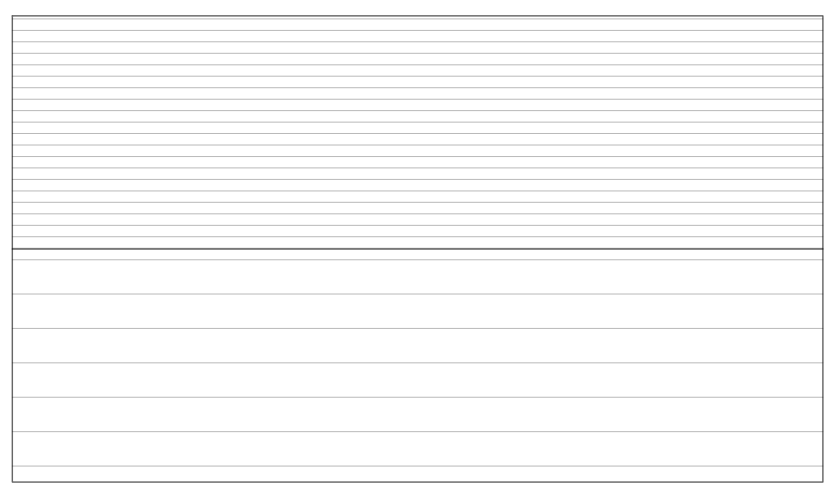

Roof Plan
Garages to Nos. 15, 16

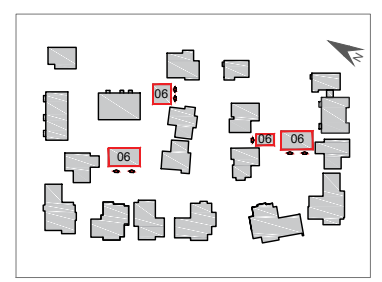

Notes:

Planning
This drawing has been prepared for workstages up to planning application purposes only and is not intended "for construction". The 'scale bar' should only be used to check the drawing has been reproduced to the correct size. No responsibility can be accepted for errors made by others in "scaling" from this drawing.

Tyack Architects Ltd own copyright of the original design work in the drawings, documents and digital files which cannot be copied, loaned or disclosed without written agreement. Please refer to our Standard Terms of Business.

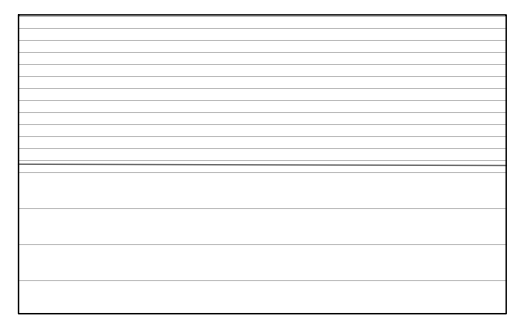
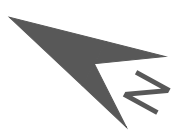

Roof Plan
Garages to Nos. 06, 07, 08

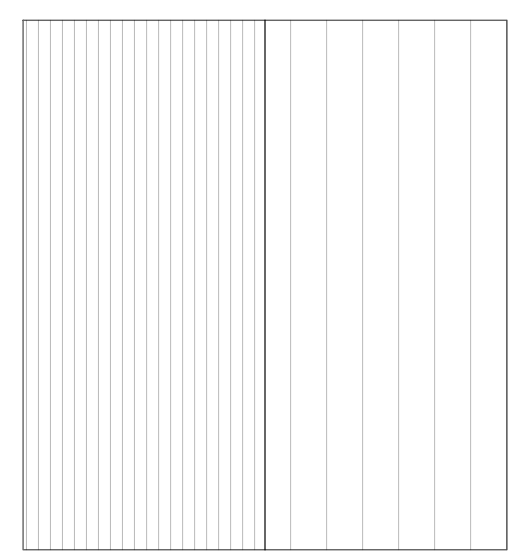
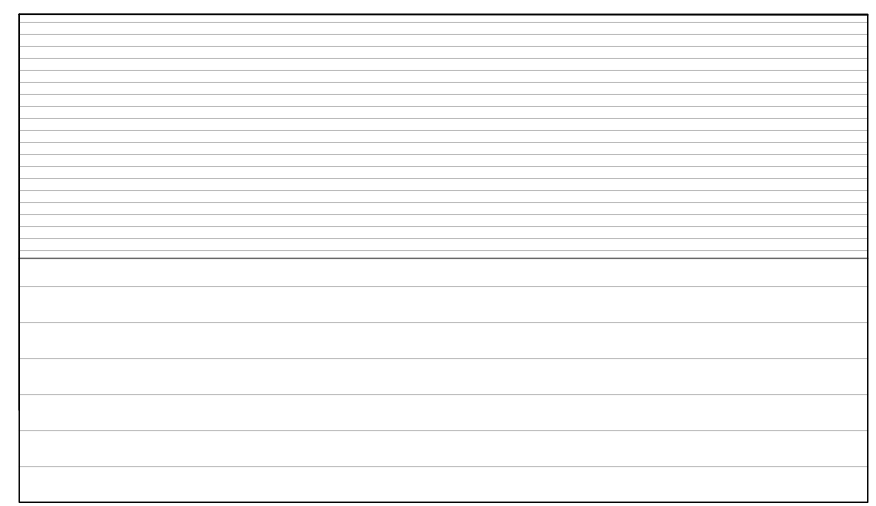

Roof Plan - Garages to Nos 17 &18

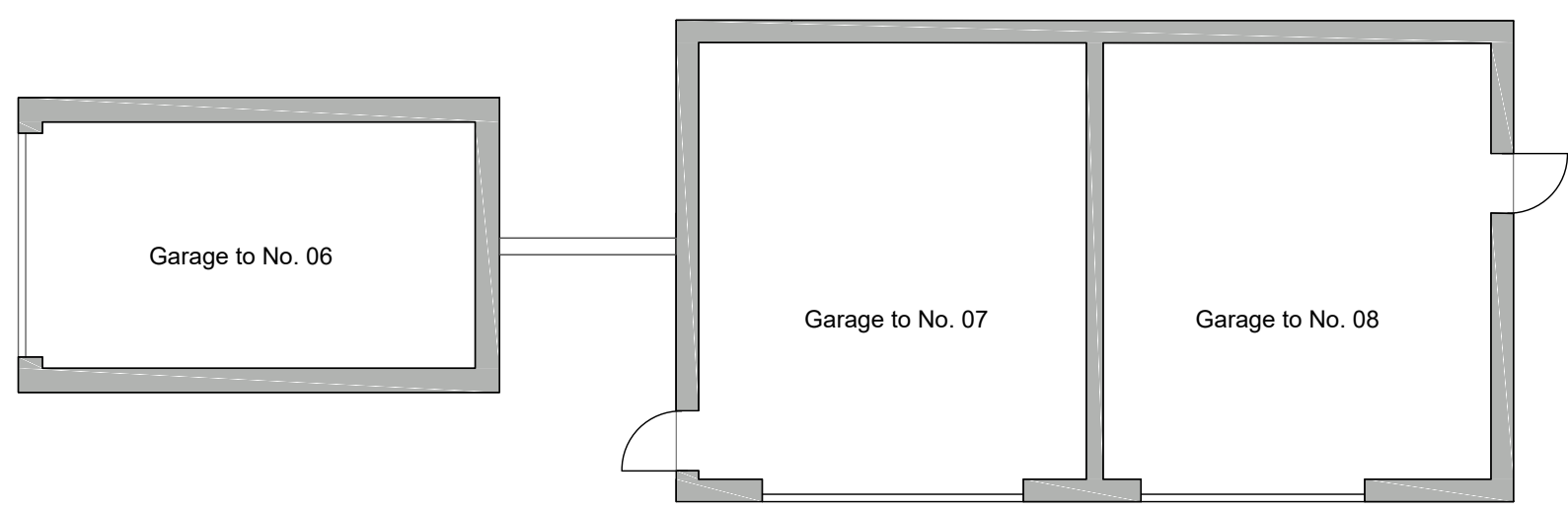

Plan
Garages to Nos. 06, 07, 08

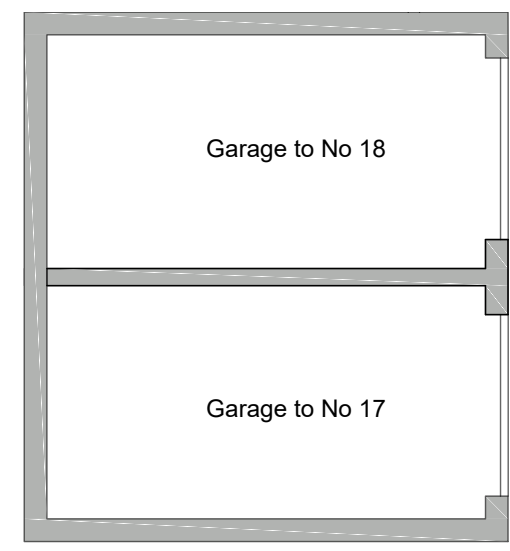

Plan - Garages to Nos 17 &18

revision	description	date	by
	PLANNING		

Tyack ARCHITECTS
 Tyack Architects Ltd
 The Mann Institute,
 Oxford Street
 Moreton-in-Marsh
 Gloucestershire, GL56 0LA
 t: 01608 650 490
 f: 01608 651 863
 e: mail@tyackarchitects.com
 w: tyackarchitects.com

title Plans - Detached Garage Blocks

project Proposed New Houses at Middle Court Upper Rissington

client Mr. A Beadman

date Nov 2017 scale 1:100 @ A3

drawn NM

checked SC number 2372_168

Copyright © Tyack Architects Ltd.