

Proposed First Floor (No Change)

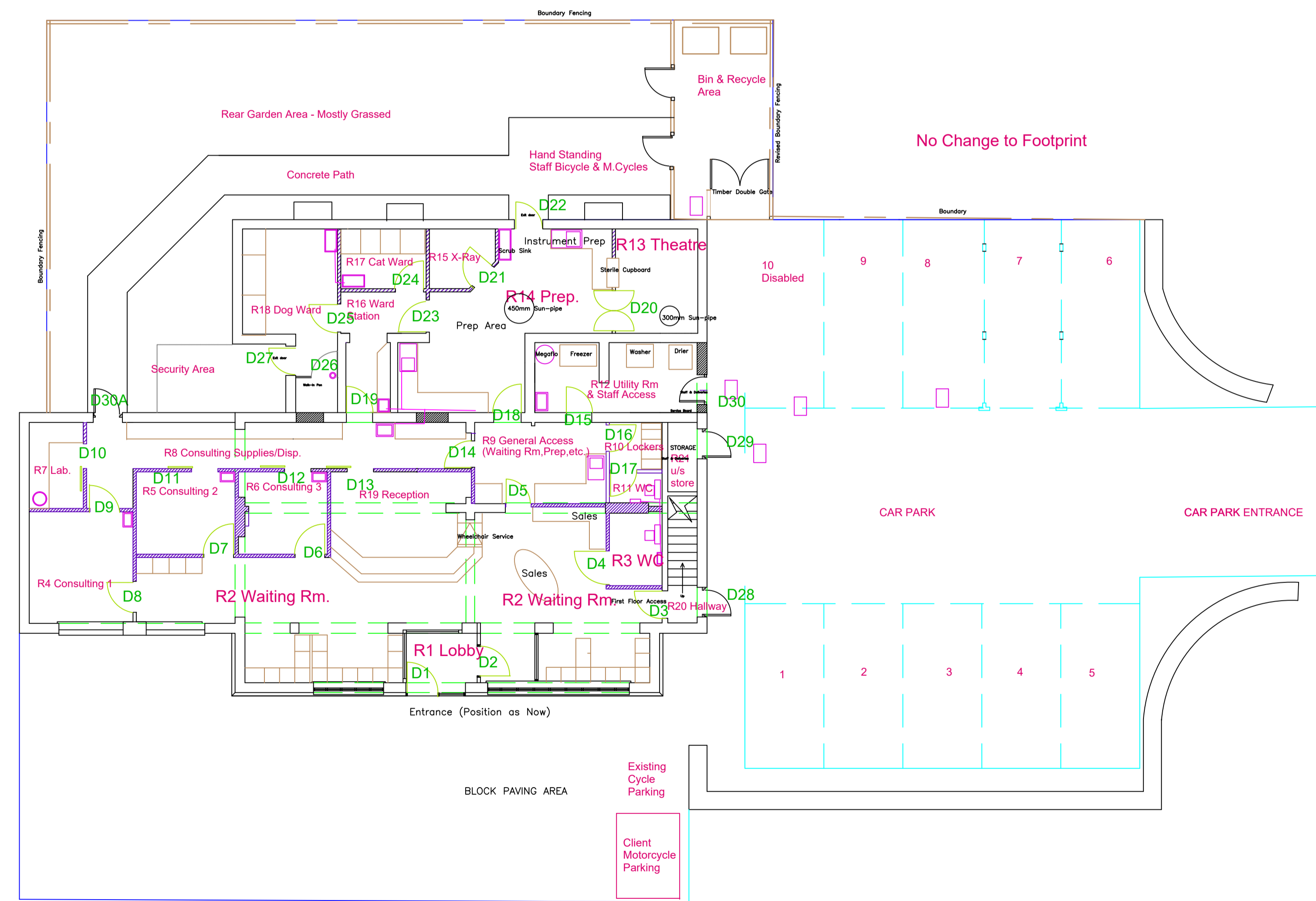

Proposed Ground Floor

Contact:

James M Wishart
& Associates
P O Box 43
North Muskham
Newark on Trent
NG23 6EJ

Dragon Vets
Prestbury Park
New Barn Lane
CHELTENHAM
GL50 5SH

Proposed Vet. Branch
8a & 8b Sopwith Road
Upper Rissington
GL54 2NL

PROPOSED GROUND
FLOOR LAYOUT,
RESTORED CAR PARK,
RECYCLE STORE, ETC.

WA758-Dragon-PrPlan-M

Scale. 1:100 @ A1

March 2019

E Mail: wishart.assoc@live.co.uk

T: 01636 674480